

Kurzbedienungsanleitung/ Quick operation guide

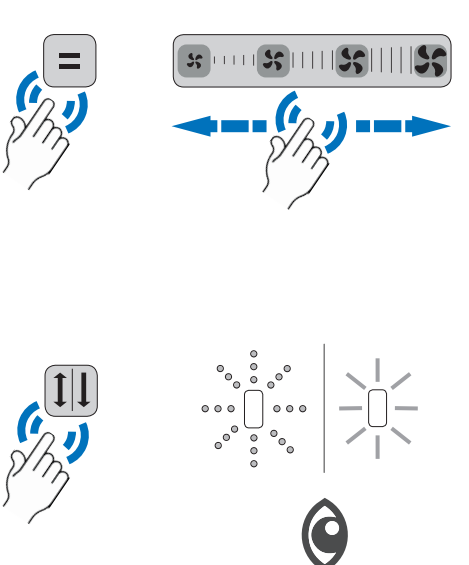

Touch
&
Slide

Allgemeine Bedienung • General handling • Operazione generale • Opération générale

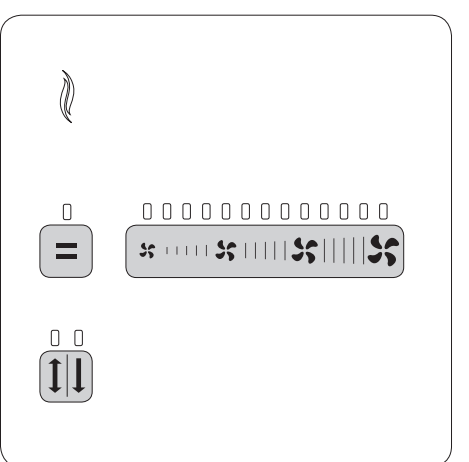

Erstaktivierung • First activation • Attivazione iniziale • Déclenchement initial

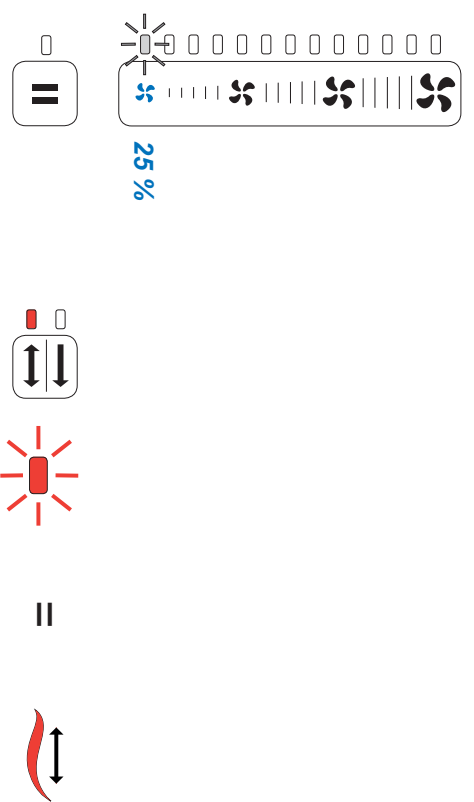
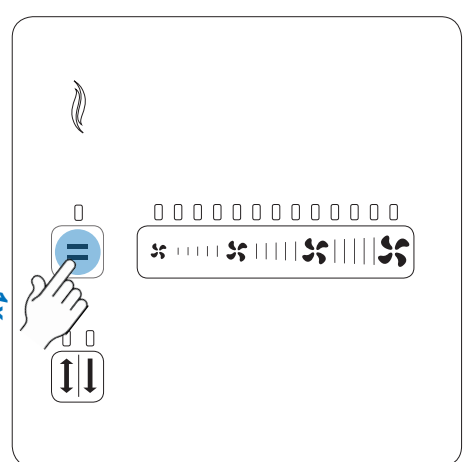

Betriebsart **Wärmerückgewinnung** und **Durchlüftung einstellen** • Setting **heat recovery** and **cont-
nuous ventilation** mode • Impostazione delle modalità **Recupero di calore** e **Aerazione unidirezionale**

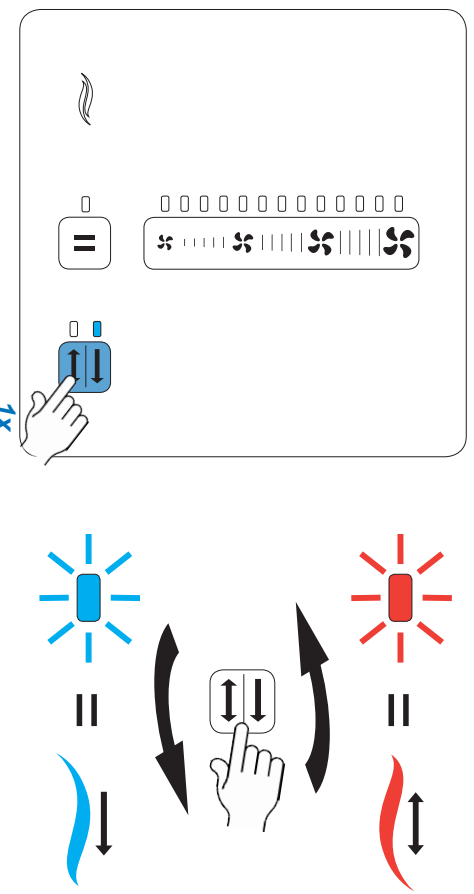
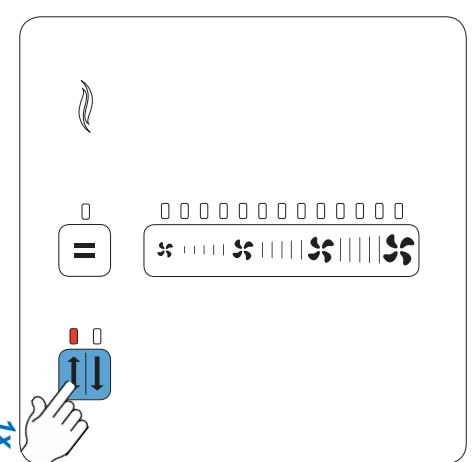

Leistung einstellen • Setting output level • Impostazione dei livelli di potenza •
Réglage de la puissance

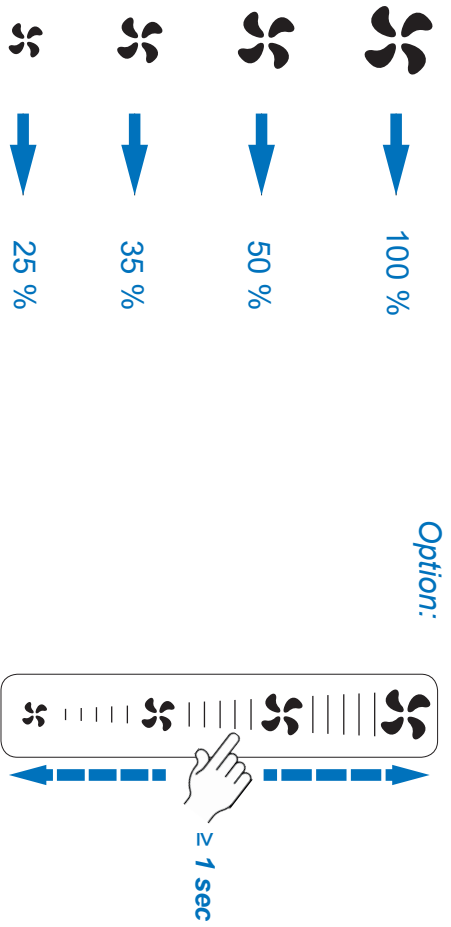
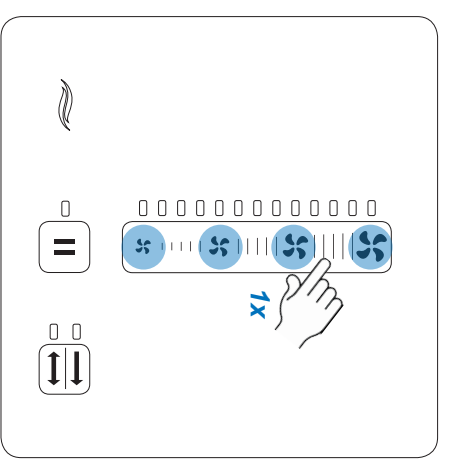

Boost Funktion einstellen • Setting the Boost function • Impostazione della funzione Boost •
Ajuster la fonction Boost

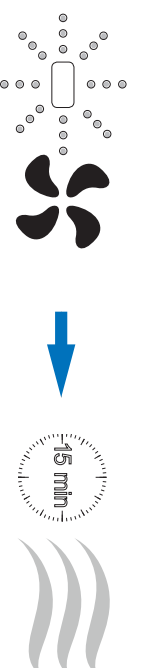
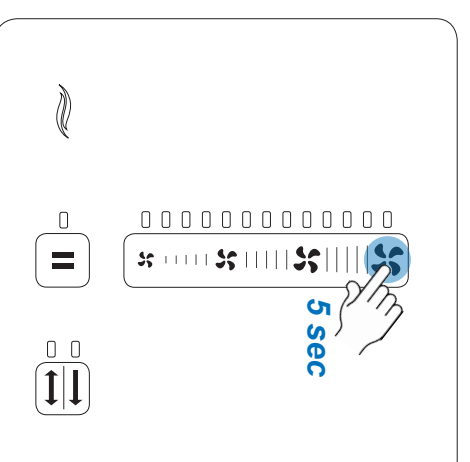

Aktivierung der Pausen Funktion • Activating the pause function • Impostazione della Pausa •
 Ajuster Pause/Mise hors tension

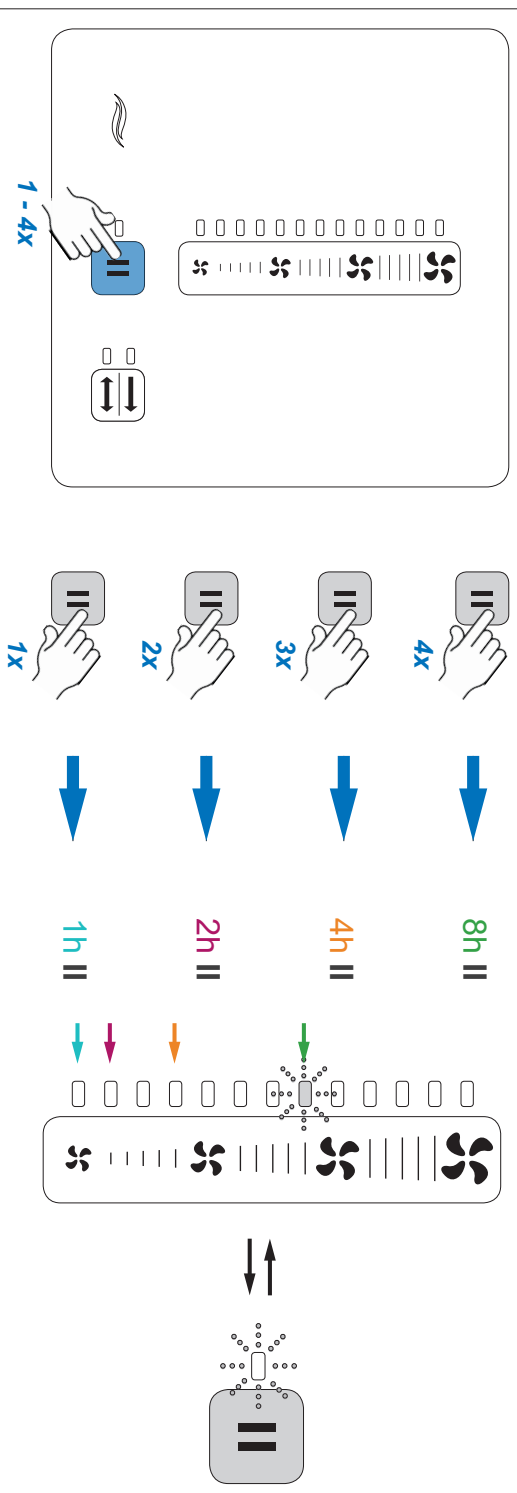

Verbleibende Pausenzeit anzeigen • Display remaining pause time • Visualizzazione del tempo di
 pausa rimanente • Affichage du temps de pause restant

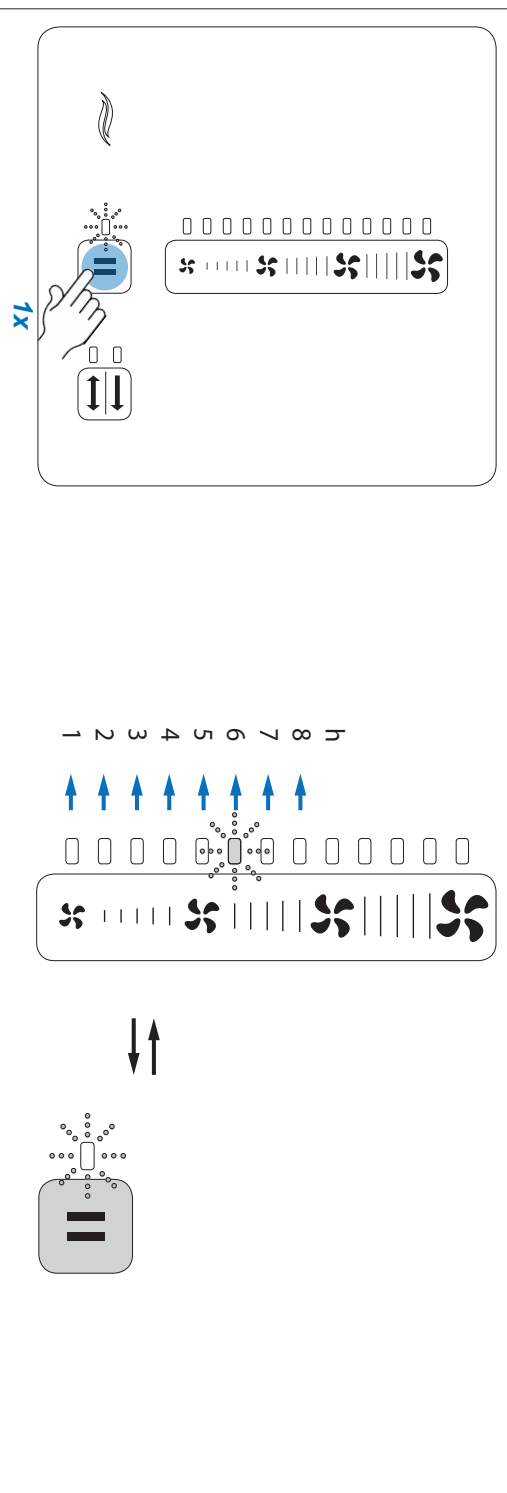

Filterwechsel bestätigen • Confirm filter change • Conferma la sostituzione del filtro •
 Confirmer le changement du filtre

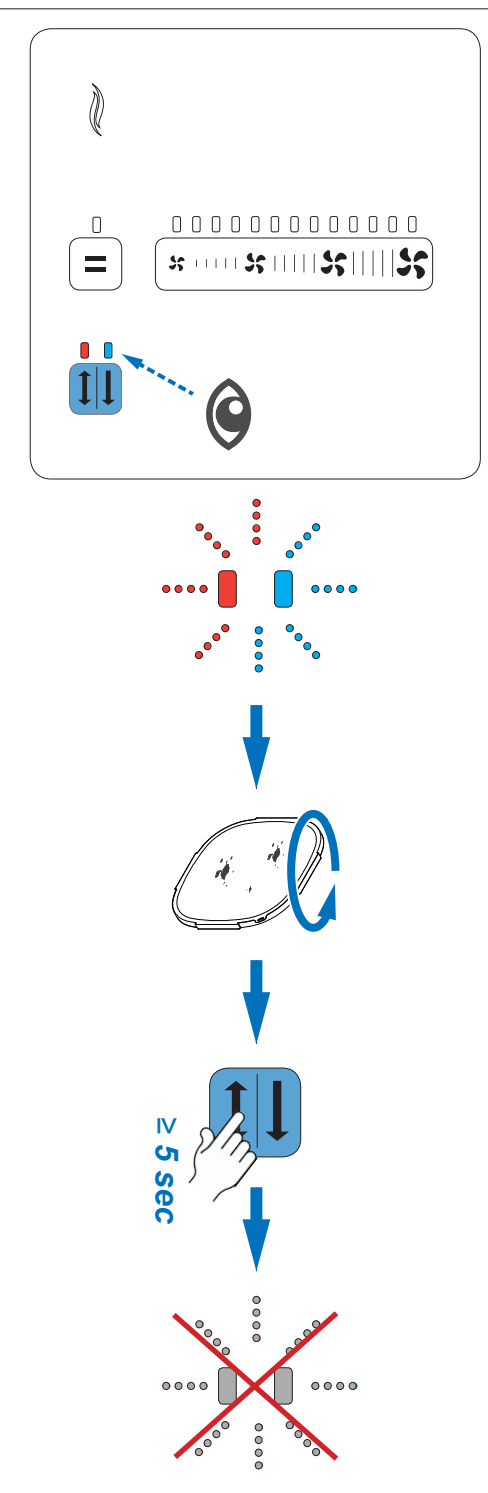

Betriebstage abrufen • Show operating days • Visualizza i giorni di operazione •
 Afficher les jours d'opération

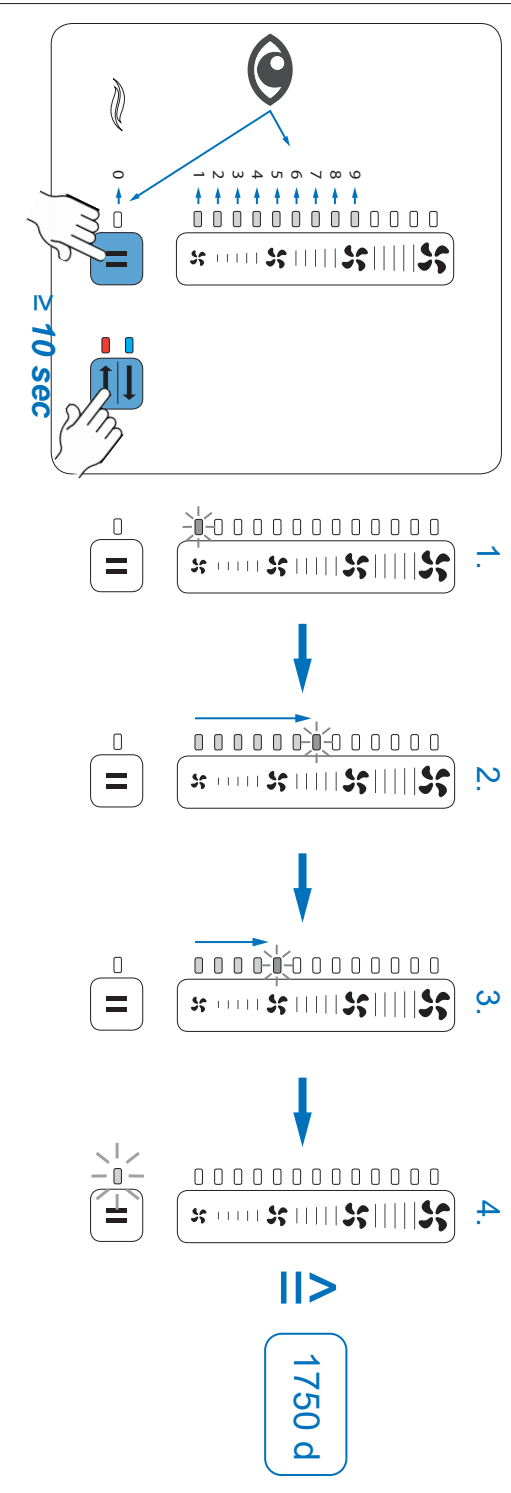

**Automatischer Energiesparmodus • Automati-
 cal energy saving mode • Modo basso consumo
 automatico • Économie d'énergie automatique**

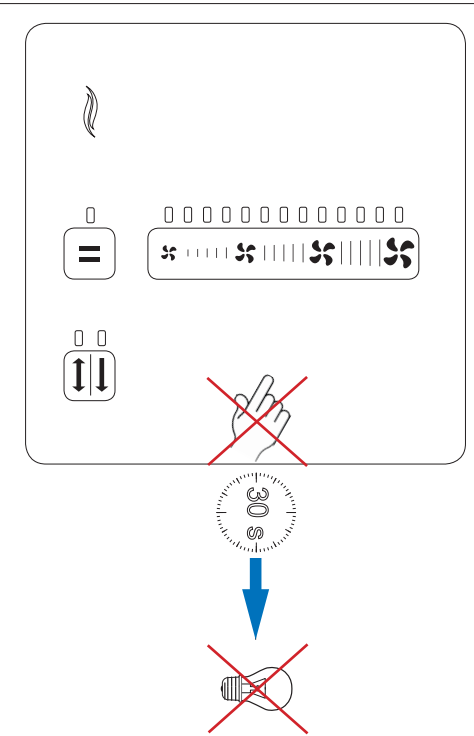

Regler ausschalten (nur Standard-Version) •
 Switch off controller (standard version only) •
 Spegnere il regolatore • Eteindre le régulateur

